

# MAS RAVETLLAT PLA Barcelona



## Welcome to Mas Ravetllat-Pla

The Ramón Pla Armengol Foundation is a private institution dedicated to the help of medical research, the dissemination of Christianity and the study of the most important collection of antique furniture in Europe. It has the Mas Ravetllat-Pla dedicated as a pharmaceutical laboratory, belonging to the outstanding doctor and pharmaceutical pioneer Ramón Pla Armengol, who dedicated the building to the production of drugs to combat tuberculosis, a business with which it generated great success.

Exiled during the Civil War, the building, as well as its activity, will go to the hands of his daughter, Dr Nuria Pla. At the same time, Nuria's passion for culture and the arts led her to start what would become the incredible collection of furniture and decorative art objects, with more than 800 pieces from the 14th to the 19th centuries.

Let's take a trip to the past of our pharmaceutical history with one of the most outstanding families of twentieth-century Barcelona, without forgetting the hidden secrets that each artistic piece of the house hides.

The wide variety of rooms can accommodate corporate events of different nature, excellence and uniqueness as premier reference: presentations, breakfast and dinners, conferences, commercials, fashion shows, recordings, weddings, press conferences, etc.











### Event Room

All the audiovisual equipment for the realization of an event is according to the needs of the client.

- Rac mobile megaphone
- Projector + projection screen
- Wireless microphone
- Outdoor patio lighting
- Interior lighting
- etc

### Capacity

	Surface	253,00
	Cocktail	350 pax
	Banquet	300 pax

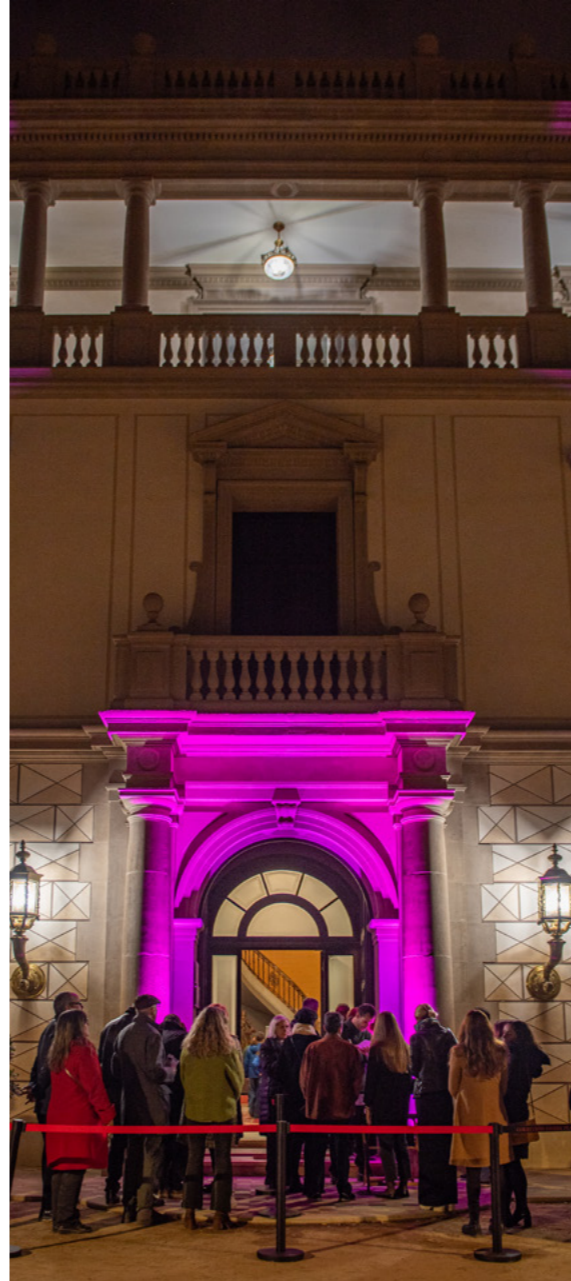
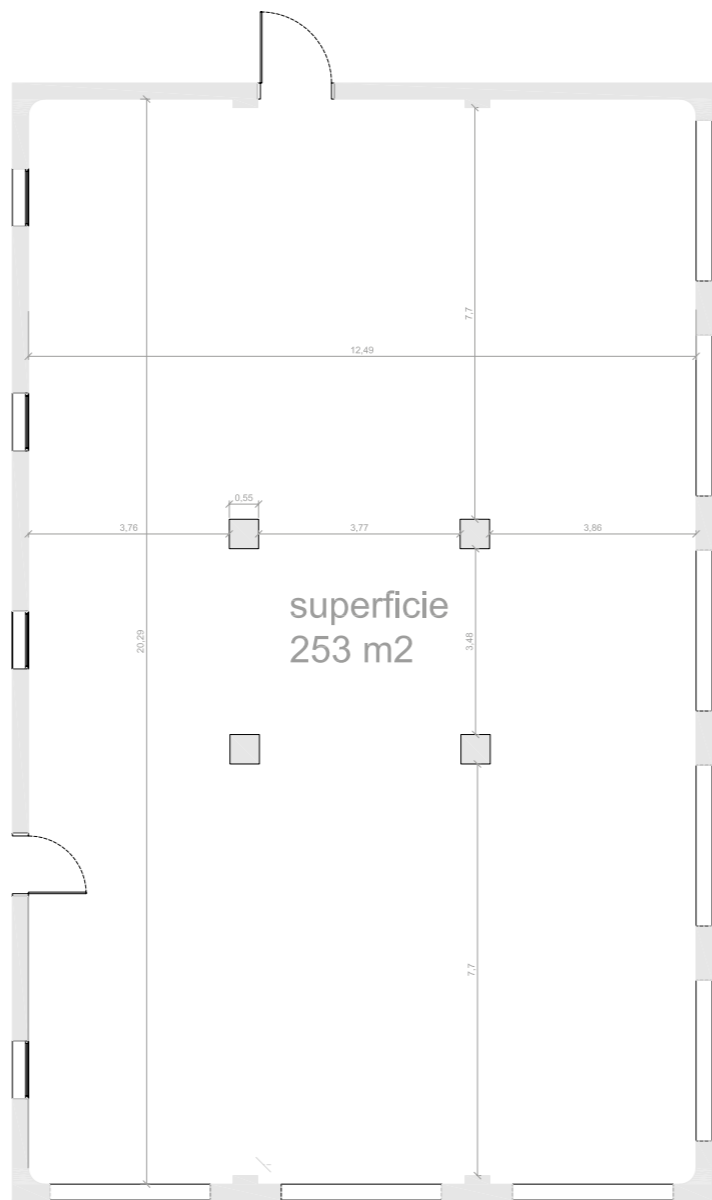

## Location

Av. de la Mare de Déu de Montserrat, 114-132  
08041 Barcelona

## GPS coordinates

41.415942, 2.1704702

Mas Ravetllat-Plan is located in the upper area of Barcelona. Specifically in the north-east area, near the Guinardó park.

## How to get there?



### Public Transport

- 1- Underground: **M** **L4** Guinardó Hospital de Sant Pau
- 2- Bus: 39, 40, N6, V23



### Private Transport

- 1- By car you can park in the Guinardó car park. Then there are about 10 min walking.
- 2- On a motorcycle you can park right in front of the main door.

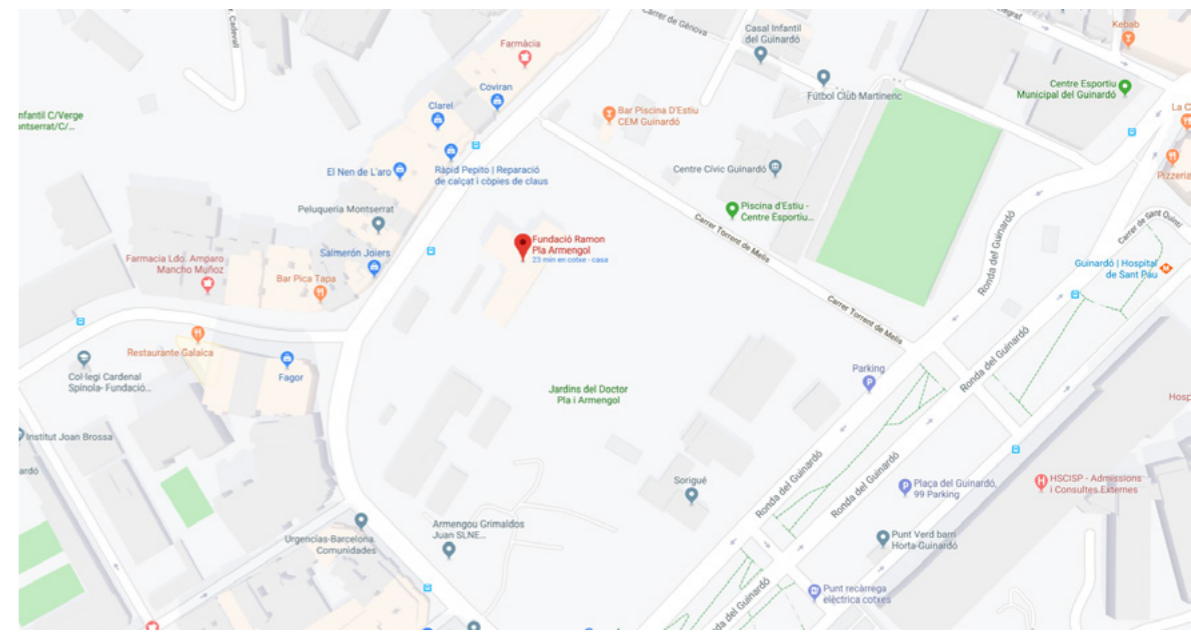
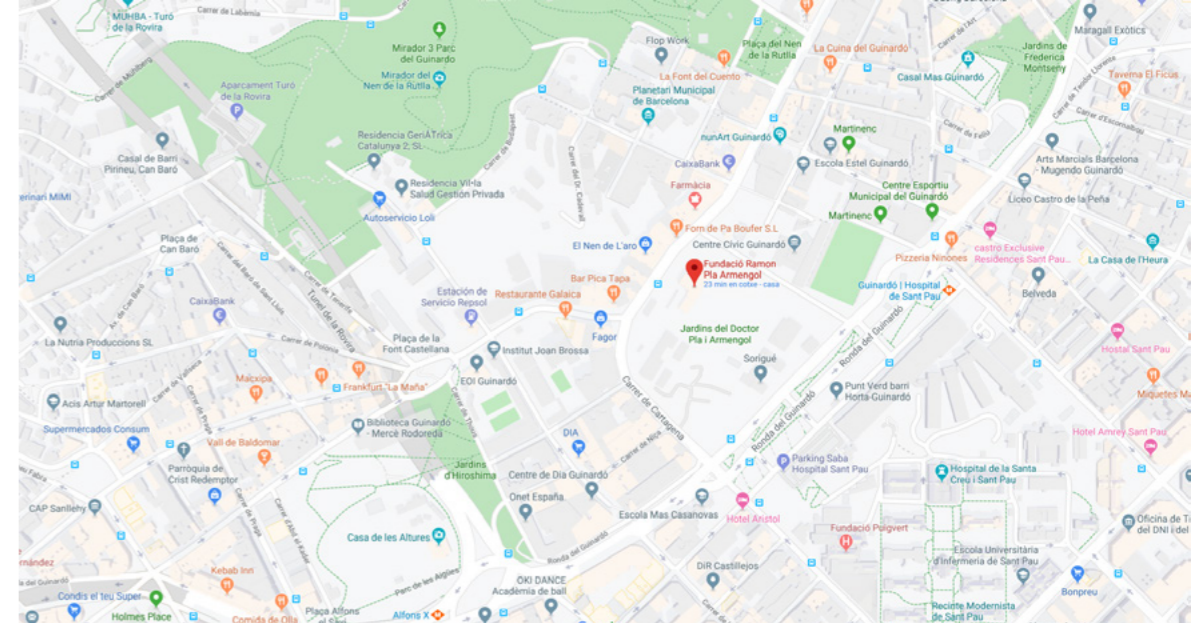





**Sternalia Productions S.L.**  
**C/ Torre dels Pardals, 33, local 3**  
**08041 Barcelona (Espanya)**  
**Tel. 93 170 17 97**  
**info@sternalia.com**  
**www.sternalia.com**